



# 6024-2Z Deep groove ball bearings

- Popular item  
- SKF Explorer

## Deep groove ball bearings

### Bearing data

[Tolerances](#),

Normal (metric), P6, P5, Normal (inch),

[Radial internal clearance](#),

Matched bearing pairs, Stainless steel  
 $d < 10$  mm, Other bearings

### Bearing interfaces

[Seat tolerances for standard conditions](#),

[Tolerances and resultant fits](#)

## Technical specification

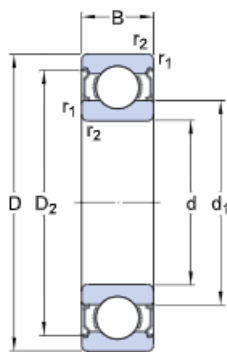

### DIMENSIONS

d	120 mm	Bore diameter
D	180 mm	Outside diameter
B	28 mm	Width
$d_1$	≈ 139.05 mm	Shoulder diameter
$D_2$	≈ 165.3 mm	Recess diameter
$r_{1,2}$	min. 2 mm	Chamfer dimension

### ABUTMENT DIMENSIONS

$d_{\xi}$ min.	129 mm	Diameter of shaft abutment
$d_{\xi}$ max.	139 mm	Diameter of shaft abutment
$D_i$ max.	171 mm	Diameter of housing abutment
$r_a$ max.	2 mm	Radius of shaft or housing fillet

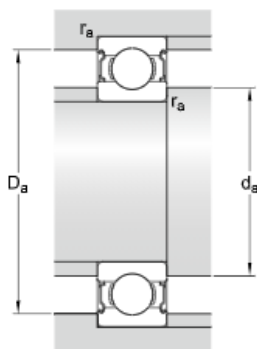

## CALCULATION DATA

C	88.4 kN	Basic dynamic load rating
C <sub>0</sub>	80 kN	Basic static load rating
P <sub>u</sub>	2.75 kN	Fatigue load limit
	7 500 r/min	Reference speed
	3 800 r/min	Limiting speed
k <sub>r</sub>	0.025	Minimum load factor
f <sub>0</sub>	15.9	Calculation factor

## MASS

	2.2 kg	Mass bearing
--	--------	--------------

## TOLERANCE CLASS

P6	Dimensional tolerances
Normal	Radial run-out